

VA CONNECTOR

Disconnectable Crimp style connectors

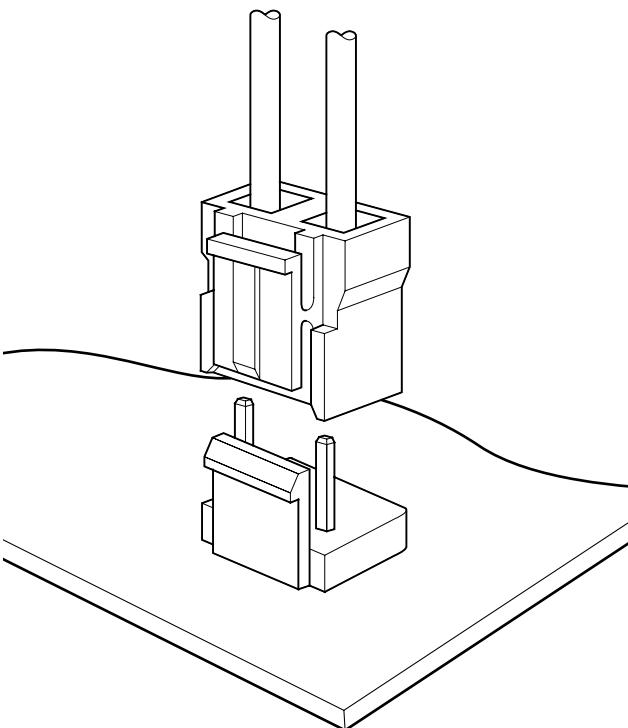

This 7.92mm (.312") pitch large current carrying capacity connector is used with primary power supply circuits and various other circuits requiring large currents. It features an anti-misinsertion construction and a reliable locking mechanism to ensure maximum safety.



Features

• **Box contact**

This connector has the box-shaped contact. The reliable NV connector can be used in a wide variety of applications, from low-voltage, low-current signal circuits to power supply circuits having a relatively large capacity.

• **Compact connector with a large capacity**

Even though this connector has a large current carrying capacity (7A), it is compact, with a mounting height of 17.5mm (.689").

• **Secure contact and mounting**

The housing has an arm lock mechanism which prevents the connector from working loose due to vibration. The mechanism also prevents misinsertion (misalignment or reverse insertion).

Specifications

- Current rating: 7.0A AC, DC
- Voltage rating: 250V AC, DC
- Temperature range: -25°C to +85°C
(including temperature rise in applying electrical current)
- Contact resistance: Initial value/10mΩ max.
After environmental testing/20mΩ max.
- Insulation resistance: 1,000MΩ min.
- Withstanding voltage: 1,200V AC/minute
- Applicable wire: AWG #20 to #18
- Applicable PC board thickness: 1.6mm(.063")

Standards

Recognized file No. E60389

Certified file No. LR20812

File No. R75122 (conforms to DIN/VDE 0627)

VA CONNECTOR

Contact

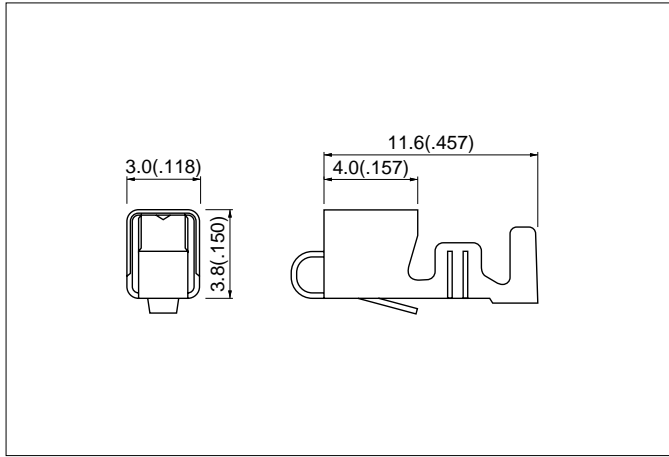

Model No.	Applicable wire			Q'ty / reel
	mm ²	AWG #	Insulation O.D. mm(in.)	
SVA-41T-P1.1	0.5 to 0.83	20 to 18	1.9 to 3.7(.075 to .146)	3,500

Material and Finish
Phosphor bronze, Tin-plated

Housing

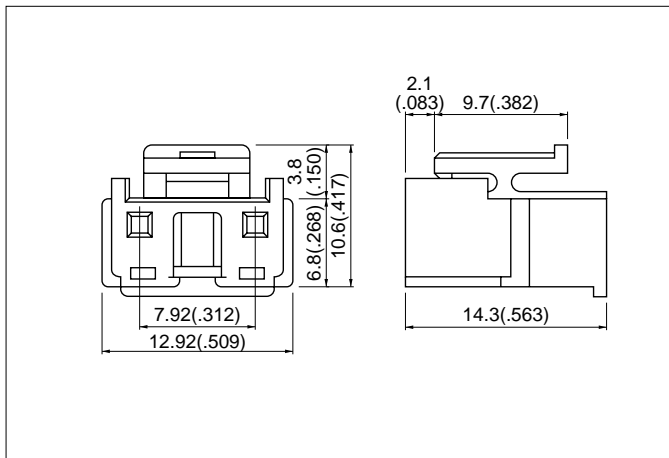

Circuits	Model No.	Q'ty / bag
2	VAR-2	1,000

Material
Nylon 6, UL94V-0, natural (white)

Locking header

Top entry type

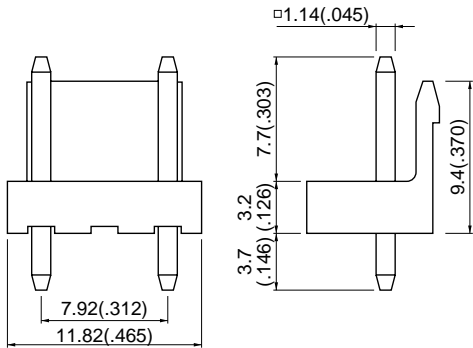

Side entry type

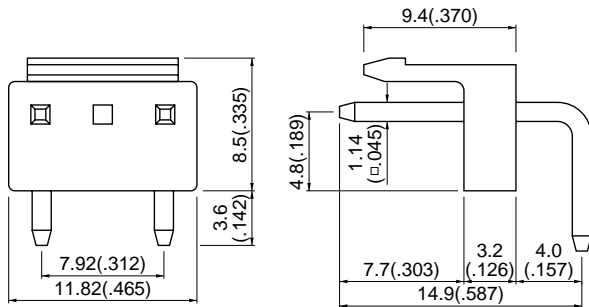

Side entry type with PCB stabilizer

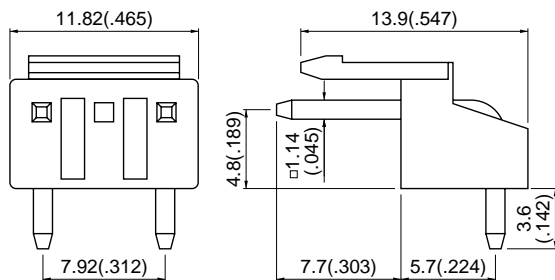

Circuits	Circuits	Model No.	Q'ty / box
2	Top entry type	B2P3-VH	1,000
2	Side entry type	B2P3S-VH	500
2	Side entry type with PCB stabilizer	S2P3-VH	500

Material and Finish

Post: Brass, copper-undercoated, tin/lead-plated
 Wafer: Nylon 66, UL94V-0, natural (white)

VA CONNECTOR

PC board layout (viewed from soldering side) and Assembly layout

Top entry type

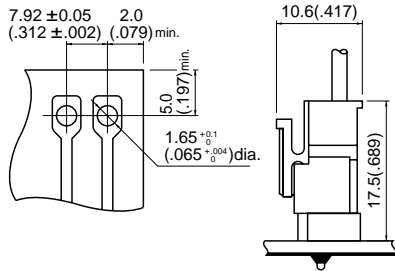

Side entry type

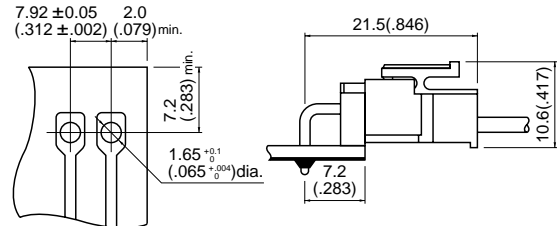

Side entry type with PCB stabilizer

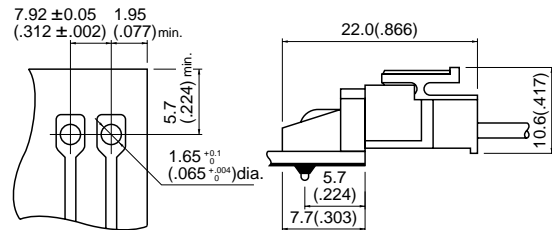

Note:

1. Tolerances are non-cumulative: ± 0.05 mm ($\pm .002$ in) for all centers.
2. Hole dimensions differ according to the kind of PC board and piercing method. The dimensions above should serve as a guideline. Contact JST for details.